

**TIMER RELÈ
TIMER RELAY**

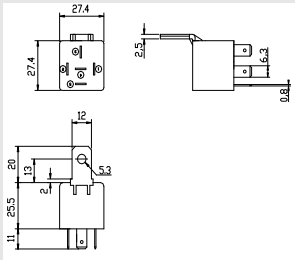

A

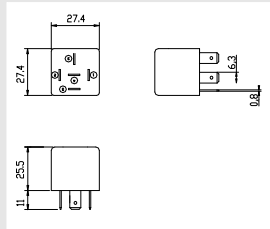

B

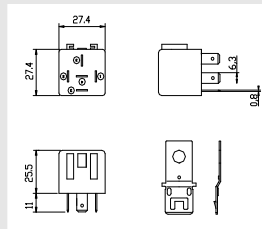

C

**SCHEMA CIRCUITO
CIRCUIT DIAGRAM**

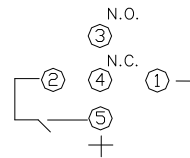

tensione nominale nominal voltage	12v
limiti di funzionamento operating limits	10V...14V
tensione di eccitazione pick-up voltage	> 9V
potenza nominale a 23° contact rating at 23°	20A
temperatura ambientale di funzionamento operating temperature	-25° C....+80° C
terminali 1-2-3-4-5 pins 1-2-3-4-5	ottone stagnato tin-plated brass
dimensioni terminali dimension pins	standard 6.3x0.8
particolari plastici plastic parts	poliammide con fibra di vetro polyamide
peso weight	19.2 gr (A) 18.0 gr (B) 18.2 gr (C) + 0.3 gr (staffa metallica/metal bracket)

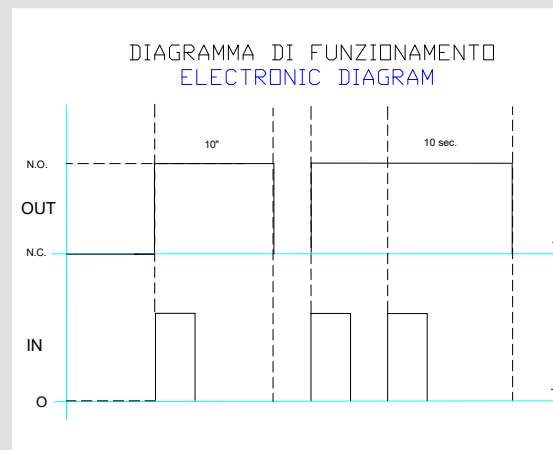
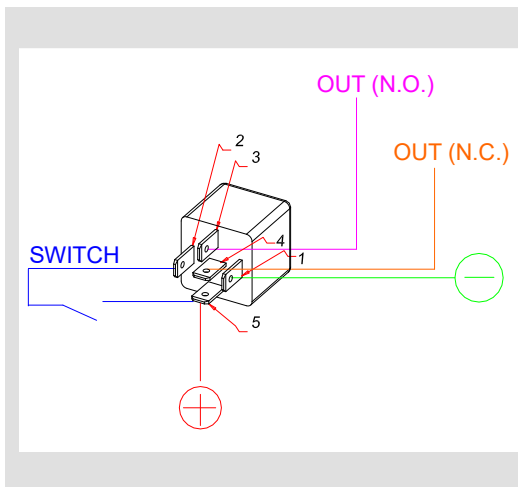

calotta
cup

12V

A	0912112711
B	0912122711
C	0912142711